

Laid down by a Scale of 100 Perches to an Inch

No 19.

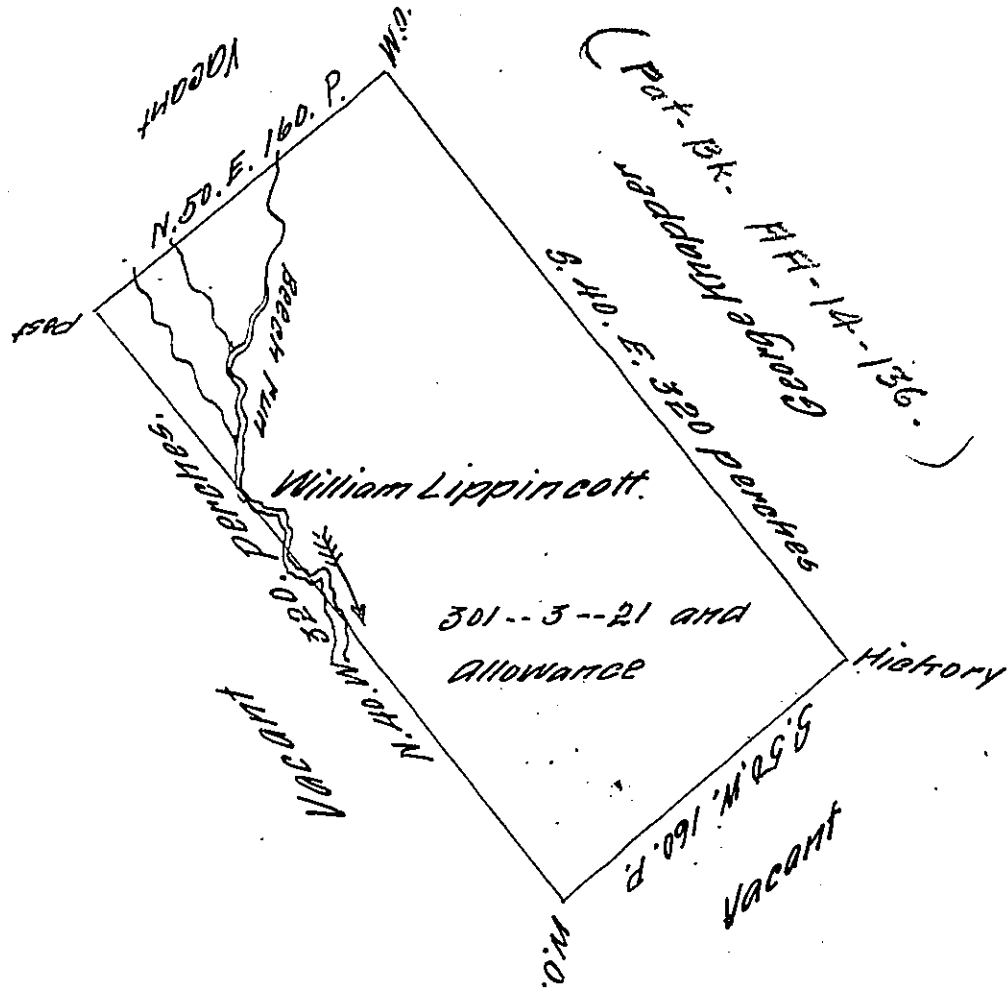

In pursuance of a Warrant Dated Novem^r 8th 1773 was Sur-
veyed the 20th day of Decem^r 1773 to William Lippincott
the above described Tract of Land situate adjoining
Poplar Run and adjoining & below Lands granted to
George Krappner in the County of Westmoreland contain-
ing three hundred and and one acres three quar-
of an acre and twenty one Perches with the Usual Allow-
ance of six acres p. Cent for Roads &c^s

p^r W^m Thompson D.S.

To John Lukens Esq^r
Surv^r Gen^l

IN TESTIMONY that the above is a copy of the original remaining on file in
the Department of Internal Affairs of Pennsylvania, made
conformably to an Act of Assembly approved the 16th day of
February, 1833, I have hereunto set my Hand and caused
the Seal of said Department to be affixed at Harrisburg,
this fifth day of April 1911.

Nancy Howell
Secretary of Internal Affairs.